

1.a. Property Name, Historic		14. MDAH Inventory Code 014
1.b. Property Name, Common Classy Creations/Ajax Diner		15. County Lafayette
2. Property Address 118-122 Courthouse Square (106-108 South Lamar Avenue)		16. City Oxford
3. Legal Description 86Q:168		20. USGS Quad Map
19. Ownership private	22. Condition fair	21. UTM Reference
4. Former/Historic Uses retail	5. Present Use retail	24. Principal Materials brick
6 & 7. Significant persons, events, themes, including dates of association		
8. Date of Construction ca. 1875	9. Historic Changes	23. Post Historic Changes stucco ca. 1970
10. Architect	11. Builder/Contractor	25. Architectural Style

13. Outbuildings or Secondary Features (use sep. form if important)

12. Brief Description: Two-story, five-bay, brick masonry commercial block with Italianate influence, built ca. 1875. Flat roof covered with built-up asphalt roofing, with stepped parapet and simple corbeled cornice. Exterior walls covered with stucco veneer. Windows are 6/6 double-hung replacement sashes, set in reduced reveals, and multi-light fixed and operable replacement doors. A cast iron balcony has been added over the storefront for #122. Storefront at #122 is altered with recessed single-light, fixed

30. Historical Information: This property is identified locally as the former Oxford Opera House and City Hall building, dating to ca. 1875. The Sanborn maps seem to support this contention; however, changes in the building foot print over time suggest major periods of alteration on the interior and the rear in the late-nineteenth and early twentieth century. A fire led to some of the existing facade alterations in ca. 1940.

31. Historical Contexts:

33. Sources of Information:

MISSISSIPPI HISTORIC RESOURCES INVENTORY

Page 2

32. Additional Remarks or Information: #12, cont'd.: display windows, brick bulkheads, and s single-light door topped with a single-light transom and and single-light sidelights; the storefront for #118-20 is altered with single-light transom, single-light display windows, and two two-panel doors with a single-light transoms.

35. Owner's Name and Address

36. Photographer/Source
John Hopkins

37. Photo Roll/Frame
3551:27

38. Photo Date
January, 2000

39. Form by Hopkins & Associates, Memphis, TN

40. Survey Project Oxford

Date of Form January, 2000

Attach Photograph



MDAH INFORMATION

26. Category

27. Functional Type

28. Registration Status/Dates
NHL
Listed NR
In NR District
Federal DOE
State Landmark
Local Landmark
In Local District
HABS/HAER

29. District Name
Oxford Courthouse Sq.
Rating C/N N
Inventory # 40

42. Other HPD Information

43. Evaluation

a. Already Listed NR
Individually Eligible
Eligible if Restored
Contribute to District
Apparently Not Eligible
Insufficient Information
Not Extant

b. Area(s) of Significance

c. Evaluated by/date

118-122 W.
COURTHOUSE SQ.

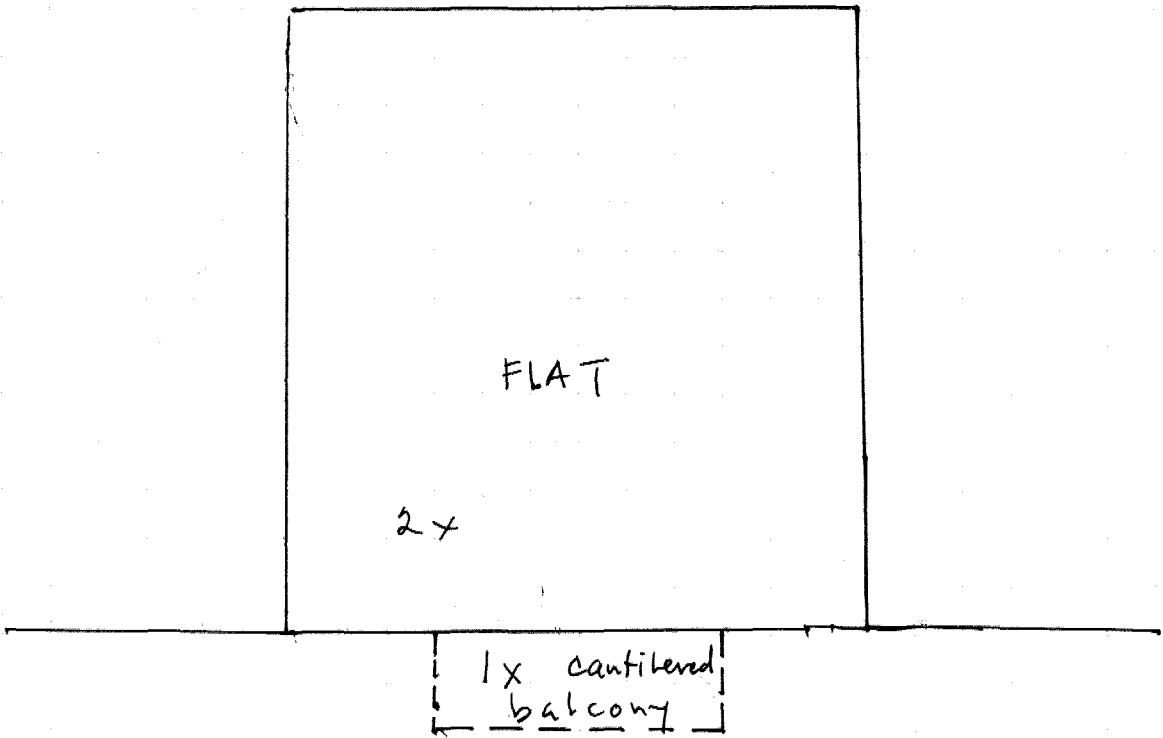

118-122 W. Courthouse Sq. → N